



**C2 R2 MAX**

Version 04 – 17 December 2009



**F63**

# ***BRAKING SYSTEM***



# C2 R2 MAX

Version 04 – 17 December 2009

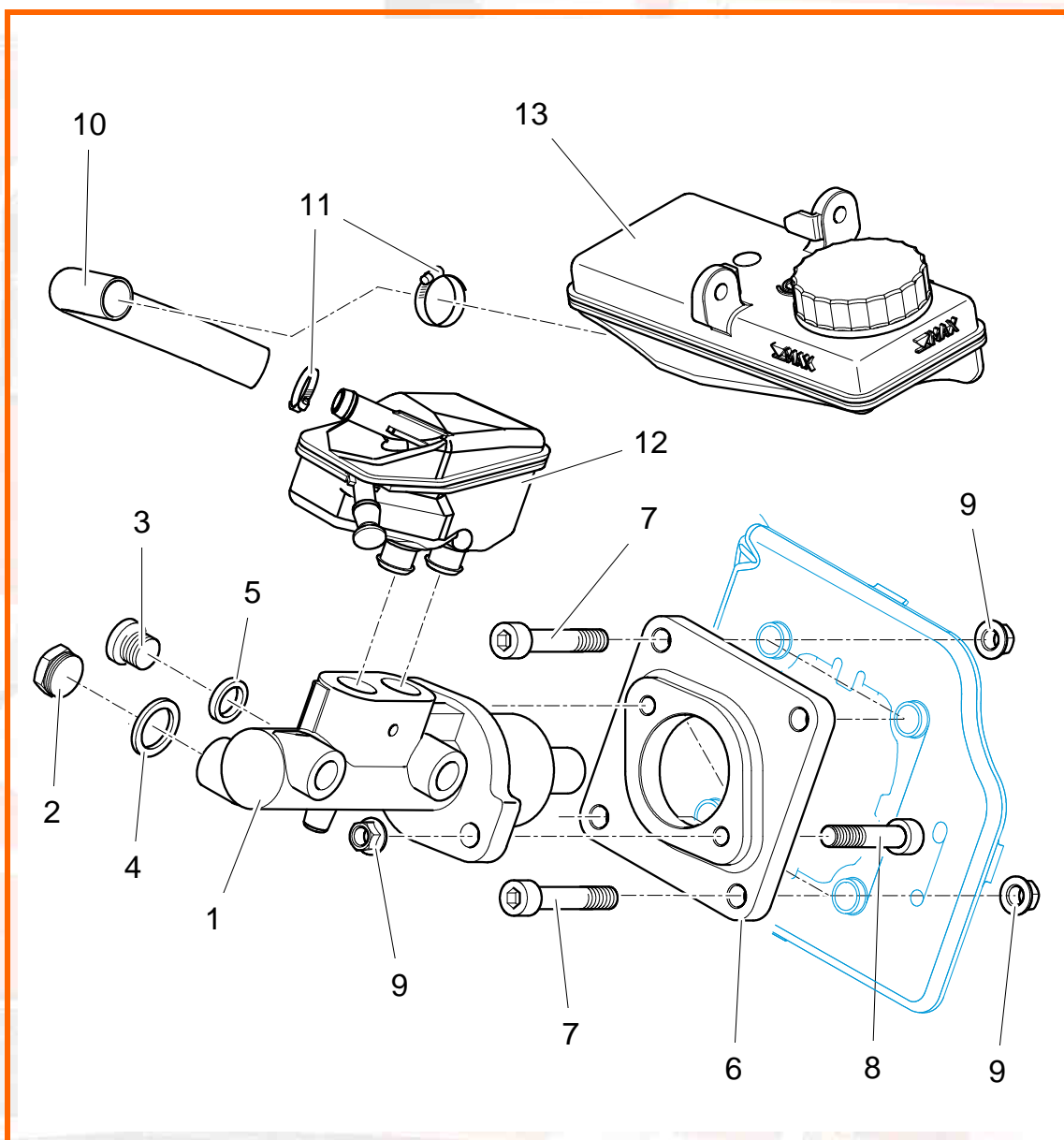

Ref	Part Number	Qty	Description
1	BCSP4601F9	1	Master cylinder D22.2
2	BCSP023244	1	Master cylinder front end cap M10x100
3	1F6363153A	1	Master cylinder rear end cap M12x100
4	BCSP015708	1	Master cylinder rear end cap
5	BCSP024988	1	Master cylinder front end cap
6	1F6362996B	1	Master cylinder spacer
7	BCSP6913H7	4	Fixing screw, spacer on body HSHC M8x125 Lg50 CI10.9
8	BCSP6913S9	2	Master cylinder fixing screw (pin type) M8x125 Lg35 CI10.9
9	BCSP7238EL	6	Lock nut, M8
10	BCSP464607	1	Flexible pipe
11	BCSP6981N1	2	Collar d12 D22 width 9
12	BCSP463597	1	Lower reservoir
13	BCSP463588	1	Upper reservoir



Fit the master cylinder spacer ([ref. 6](#)) on the body, using the screws ([ref. 7](#)) and nuts ([ref. 9](#)), as shown in the photo opposite.

NOTE: these screws are also used to fix the pedal support on the body.

Fit the master cylinder fixing screws (pin-type assembly, [ref. 8](#)) on the spacer, as shown in the photo opposite.

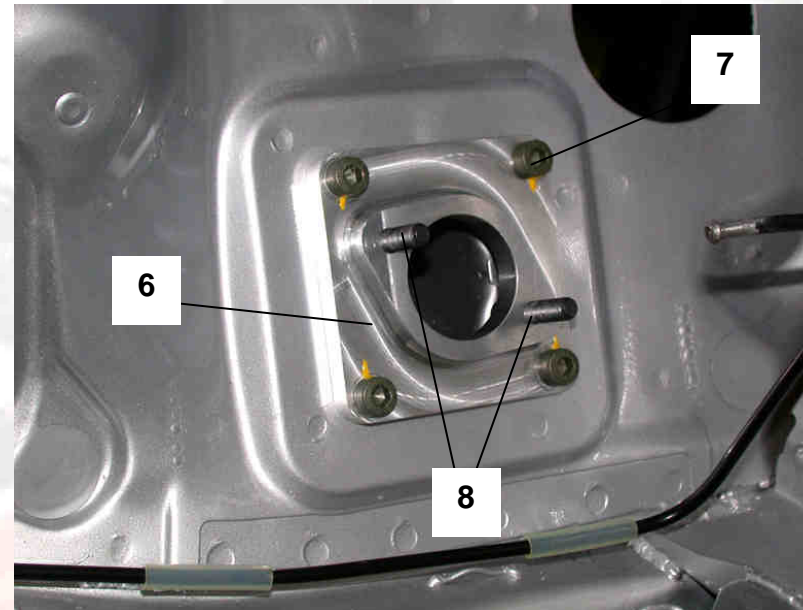

3,5 m.kg





Fit the master cylinder ([ref. 1](#)) on the spacer, using the nuts ([ref. 9](#)).

Fit the lower reservoir ([ref. 12](#)) on the master cylinder, as shown in the photo opposite.

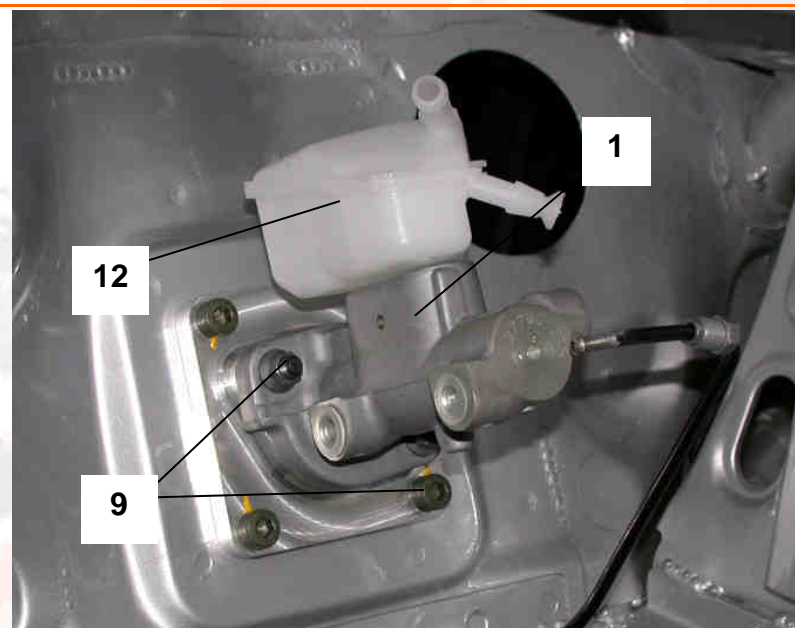

Cut the blue-coloured parts on the upper reservoir ([ref. 12](#)).







Fit the upper reservoir on its mounting bracket, in the driver's side windscreen bay.



Cut the pipe ([ref. 10](#)) to obtain a total length of 300mm.

Using the collars ([ref. 11](#)) and cut pipe, connect the two reservoirs (see photo opposite).

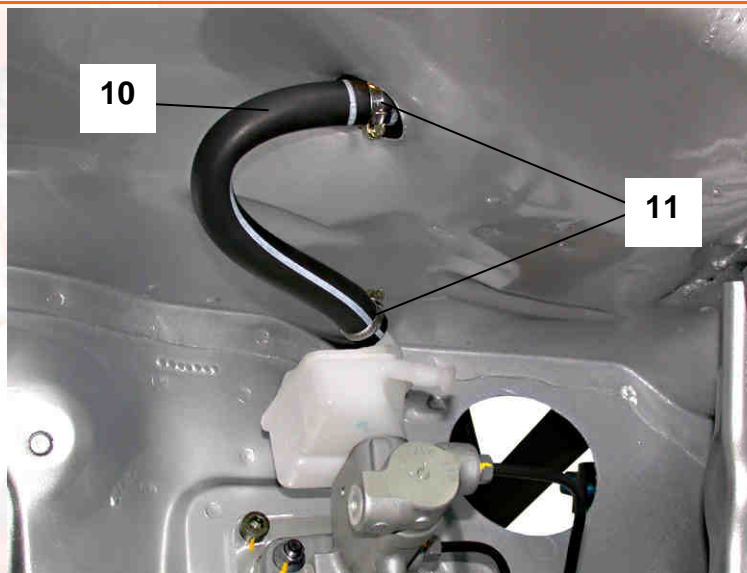



Fit the master cylinder front end cap ([ref. 3](#)) with its gasket ([ref. 5](#)) fitted, on the master cylinder, in the location shown in the photo opposite.

Fit the master cylinder rear end cap ([ref. 2](#)) with its gasket ([ref. 4](#)) fitted, on the master cylinder, in the location shown in the photo opposite.

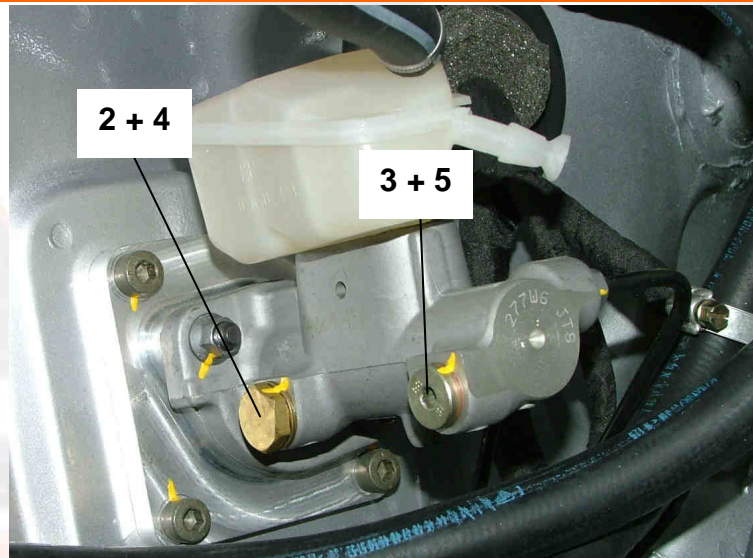

**Oil-tight**



**F63**  
**Brake circuit**



**F**  
**BRAKING**  
**SYSTEM**



# C2R2MAX

Version 04 – 17 December 2009

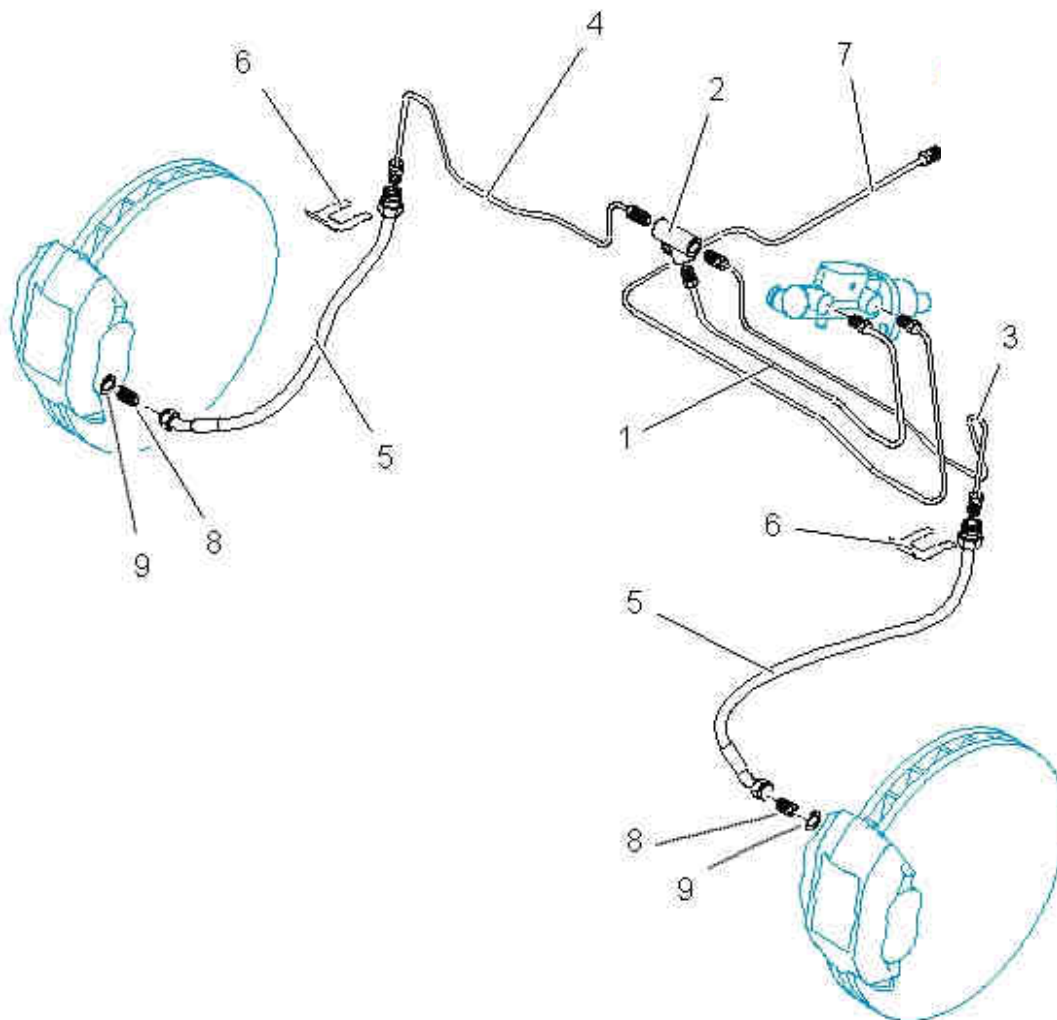

Ref	Part Number	Qty	Description
1	1F6363214A	1	Rigid pipe, master cylinder to front "T"
2	BCSP481126	1	"T" connector, 3-way
3	1F6361200C	1	Front left rigid pipe
4	1F6361201C	1	Front right rigid pipe
5	1F6360232A	2	Front brake hose
6	BCSP481419	2	Brake hose U-clip
7	1F6363213A	1	Rigid pipe, master cylinder to rear brake governor
8	1F6361349A	2	Dash3 Male / 10x100 connector
9	PS81535A10	2	Ø10,35 x 15,8 thick1 metal gasket





Fit the “T” ([ref. 2](#)) on the body, using an M6 lock nut, as shown in the photo opposite.

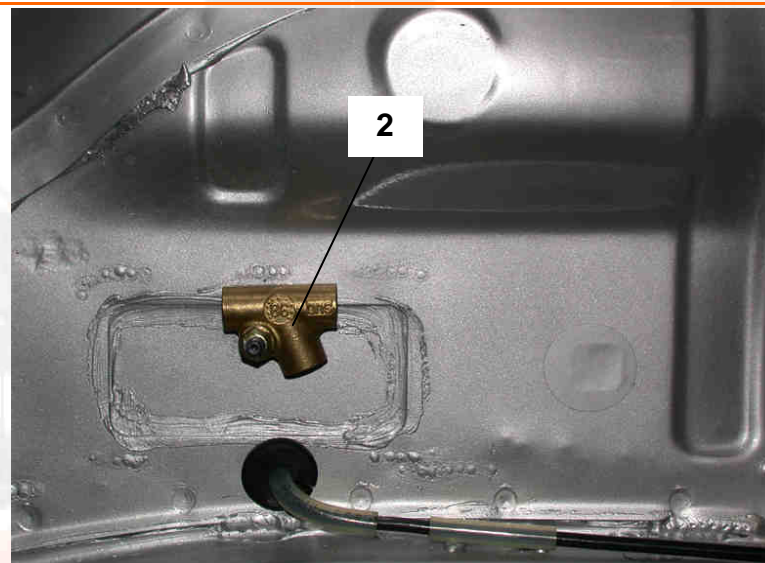

Connect the front master cylinder rigid pipe ([ref. 1](#)) to the front master cylinder and front “T”, as shown in the photo opposite.

Note: always use the master cylinder outlet on the outside!

**⚠ Make sure the assembly positions are properly followed.**

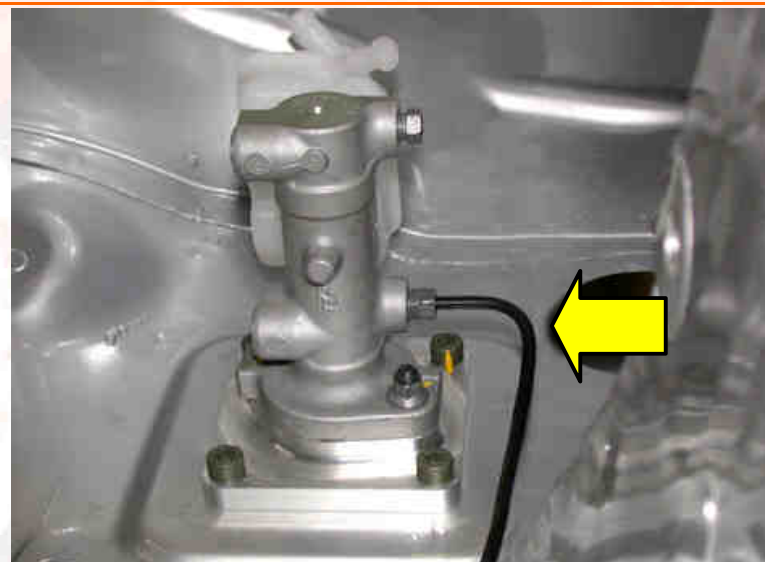

**F63**  
**Brake circuit**



**F**  
**BRAKING**  
**SYSTEM**



Fit the front right and front left rigid pipes to the front “T”, and to the front hose mounts, in the right and left wheelhouses (below).



Fit the right and left front brake hoses ([ref. 5](#)) to the rigid pipes ([ref. 3](#)) or ([rep. 4](#)), and connect the assembly to the welded mount with the staple ([ref. 6](#)), as shown in the photo opposite.

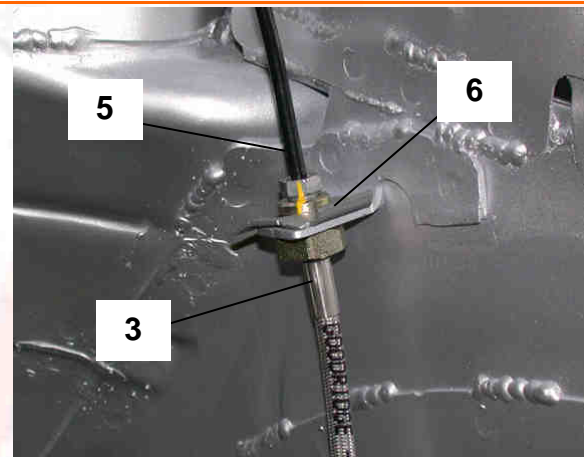



Fit the front master cylinder rigid pipe to the rear brake governor ([ref. 7](#)), as shown in the photo opposite.

Note: always use the outlet on the outside!



**Make sure the assembly positions are properly followed.**

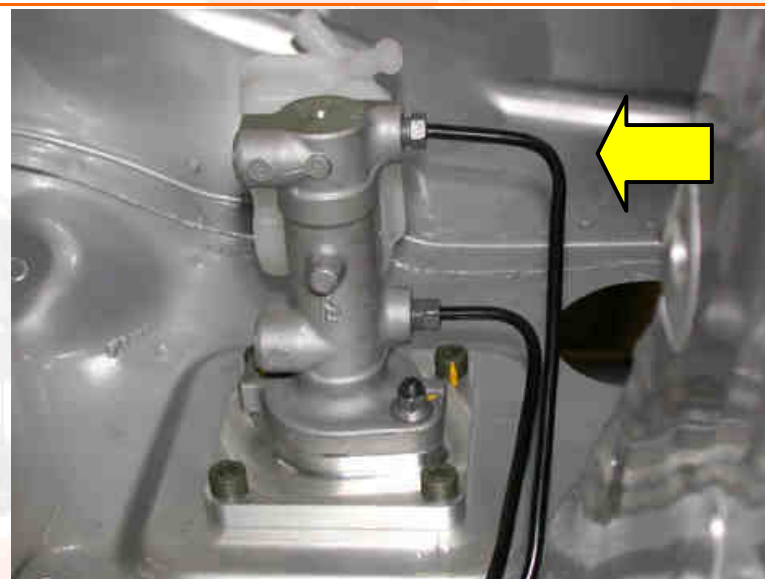



C2R2MAX

Version 04 – 17 December 2009

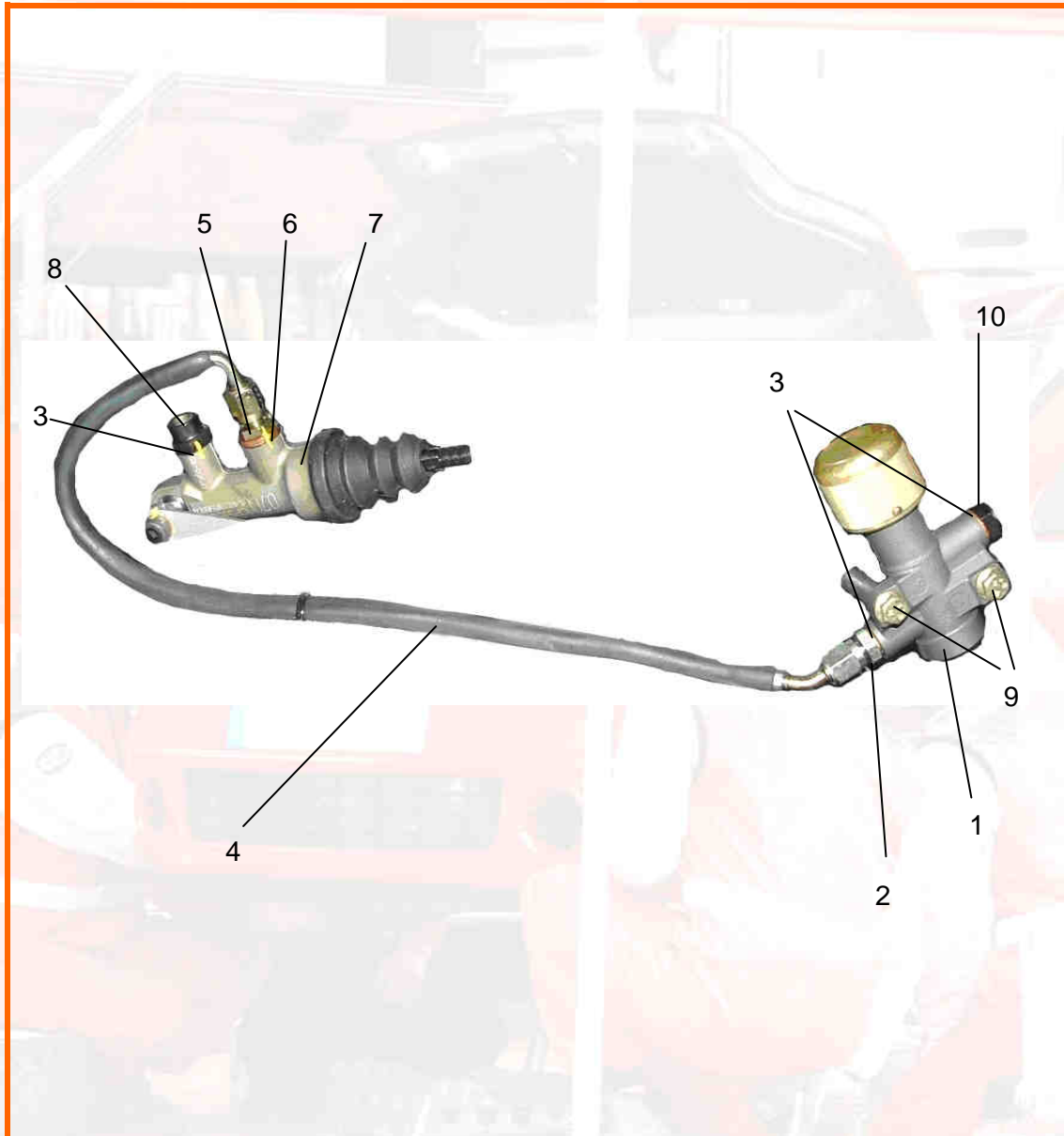

Ref	Part Number	Qty	Description
1	1F6363638A	1	AP Proportioning valve
2	1F6361349A	1	Dash3 Male / 10x100 connector
3	PS81504A10	3	Copper gasket d10.2 D13.5 Th1.5
4	1F6363637A	1	Flexible pipe, rear brake governor to hand brake master cylinder
5	1F6362702A	1	Male / male dash3 / dash4 adaptor, master cylinder inlet
6	PS81534A10	1	Copper gasket d11.2 D16.1 Th1
7	1F6362701A	1	Hand brake master cylinder
8	1F6311376B	1	Adaptateur mâle / femelle 3/8 M10 sortie maître cylindre
9	PS82017A10	2	Fixing screw M6x100 L25 CI 12.9
10	1F6360865A	1	Adaptateur M10x100 M/F
11	BCSP693586	2	Lock nut M6
12	BCSP694904	8	Washers 6x14 ép1.5





Fit the hand brake master cylinder with the "inlet" connector with its gasket (*ref. 5 + 6*), and the "outlet" connector with its gasket (*ref. 8 + 3*), as shown in the photo opposite.



**Oil-tight**



Fit the rear proportioning valve with the male-female connector with its gasket (*ref. 10 + 3*), and finally the male / male connector with its gasket (*ref. 2+3*).

Pay attention to fit the friction tongue (*rep. A*) on the proportioning valve, as shown on the opposite picture.

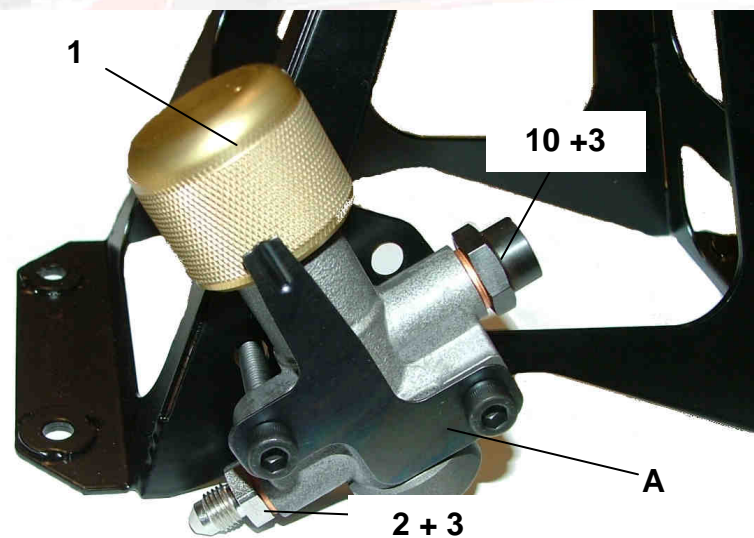

**Oil-tight**

**F63**  
**Brake circuit**



**F**  
**BRAKING**  
**SYSTEM**



Connect the proportioning valve to the hand brake master cylinder with the flexible pipe ([ref. 4](#)).

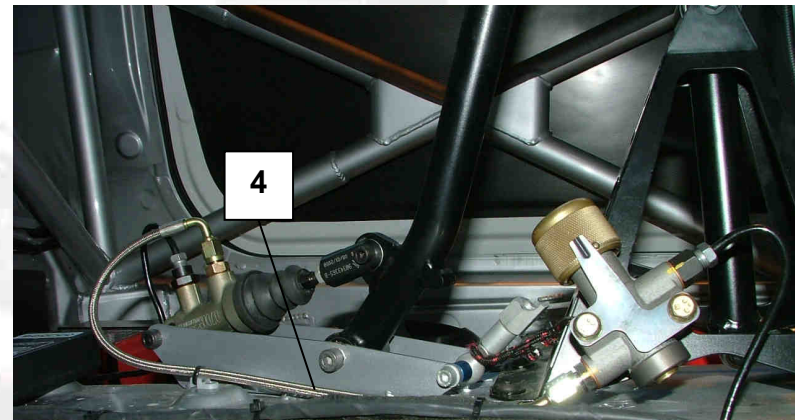

On the top of the adjustment wheel, do a sign to inform the driver about the rotation side to have more brakes on the rear (as shown on the opposite picture)





**F63**  
**Brake circuit**



**F**  
**BRAKING**  
**SYSTEM**



# C2R2MAX

Version 04 – 17 December 2009

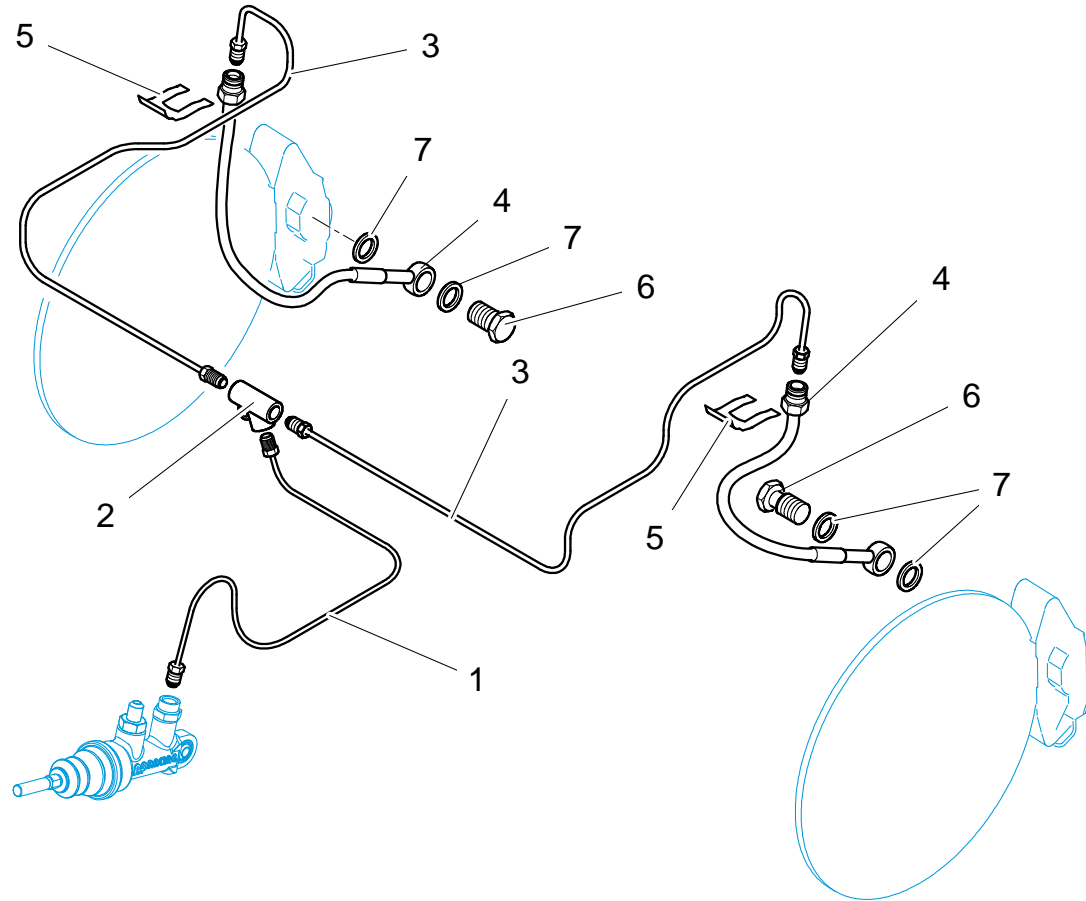

Ref	Part Number	Qty	Description
1	1F6361201C	1	Rigid pipe, rear brake governor to rear "T".
2	BCSP481126	1	"T" connector, 3-way.
3	1F6362023A	2	Rigid pipe from rear "T" to rear panel grommet.
4	1F6361152C	2	Rear brake hose
5	BCSP481419	2	Brake hose U-clip
6	1F6363230A	2	Banjo screw 3/8 24 threads
7	PS81500A10	4	Copper gasket d10.2 D13.4 Th1
8			
9			





Fit the rear “T” ([ref. 2](#)) on the body, using an M6 lock nut.



Fit the hand brake master cylinder rigid pipe ([ref. 1](#)) to the rear “T” ([ref. 2](#)).

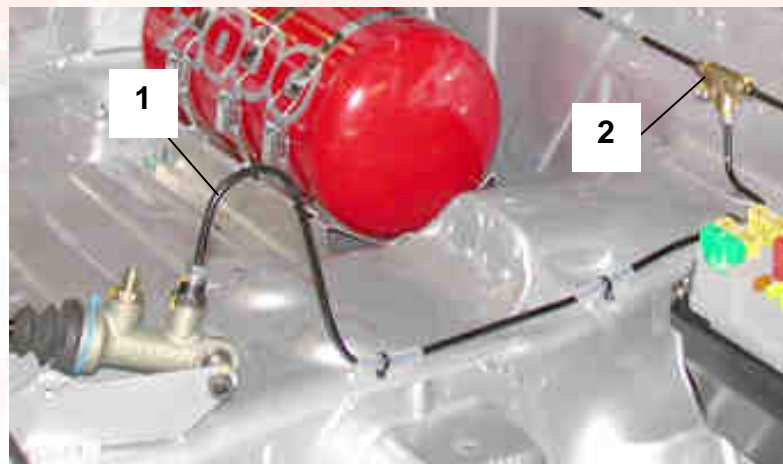

Fit the rigid pipes ([ref. 3](#)) from the rear “T” ([ref. 2](#)) to the right and left wheelhouses.



**Right Wheelhouse**

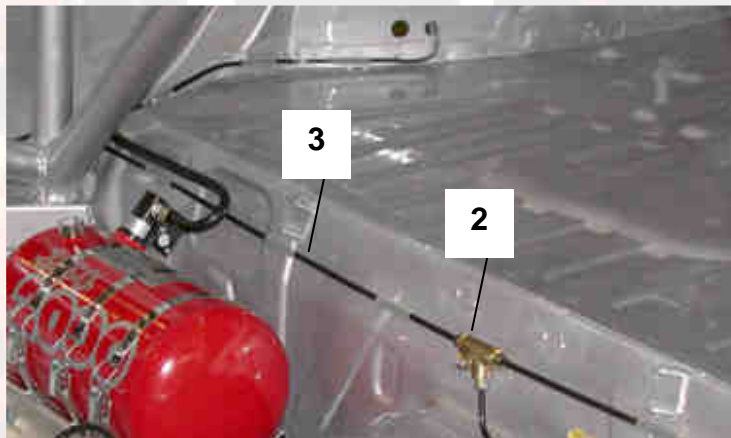

**Left Wheelhouse**

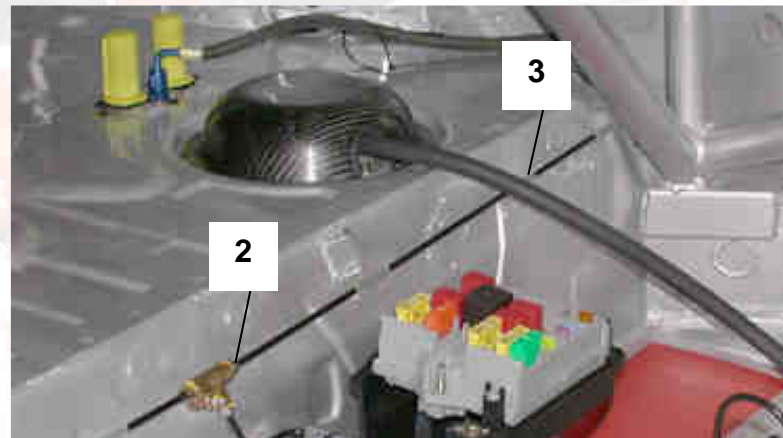



Fit the rear brake hoses ([ref. 4](#)) to the rigid pipes ([ref. 3](#)), and connect the assembly to the welded supports using U-clips ([ref. 5](#)), as shown in the photo opposite.

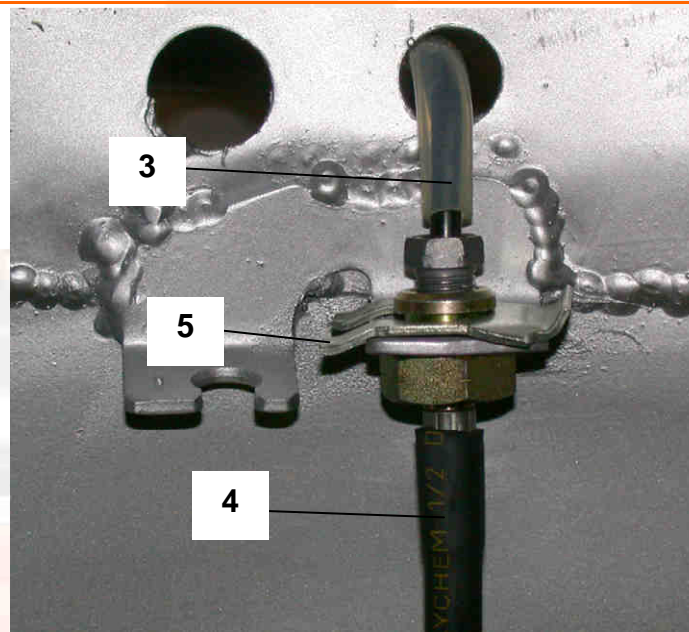

Fit the rear brake hoses to the rear brake calipers, using banjo screws ([ref. 6](#)) with gaskets ([ref. 7](#) fitted both sides of the banjo), as shown in the photo opposite.

